

peerless®

MOUNTING SOLUTIONS
FOR PROJECTORS

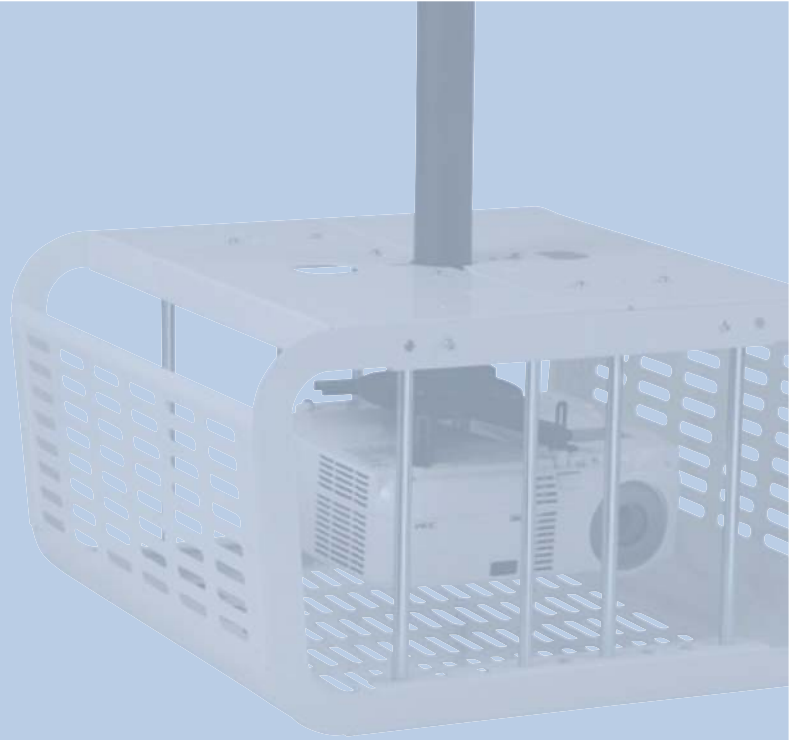



Projector Mounts, Security & Installation Accessories

Your Comprehensive Solution for All Projector Installations

Innovative and easy to install projector mounts including the industry's first precision gear projector mount

A full line of projector mount accessories for almost any application from cathedral ceilings in houses of worship to structural ceilings in home theaters, to suspended ceilings in classrooms

Four levels of security to protect projectors from vandalism or theft



Projector Mounts

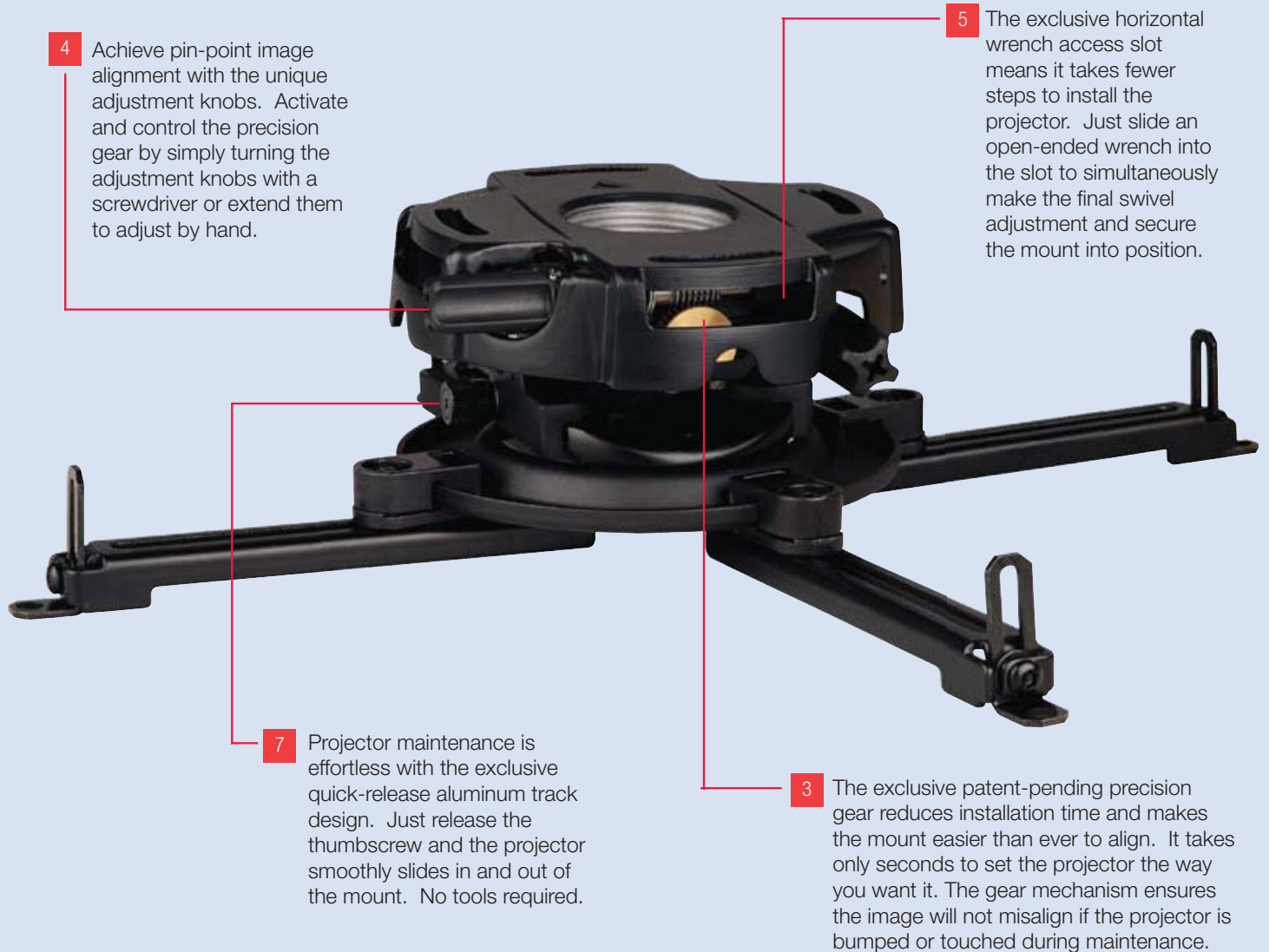

PRG Precision Gear Projector Mount:
PRG-UNV(S)(W) Spider® Universal Models
PRG-1(S)(W) Dedicated Models (projector adapter plate purchased separately)

Spider® Universal



1. Color: Black, silver or white
2. 50 lb load capacity
- 3.** Patent-pending precision gear provides accurate projector image alignment
- 4.** Two adjustment knobs control projector image alignment
- 5.** Horizontal wrench access slots make flush mounting installations fast and easy; other mounting options available with accessories
6. Pre-assembled design reduces installation time
- 7.** Quick-release mechanism to easily service projector
8. Cable management allows cables and cords to be routed through projector mount out of sight
9. Security hardware included for theft prevention
10. Tilt $\pm 20^\circ$, Roll $\pm 10^\circ$, Swivel 360° with extension column
11. Available with Spider® Universal Adapter Plate or dedicated adapter plate

Projector Mounts

PRS Series Projector Mount:

PRS-UNV(-S)(-W) Spider® Universal Models
 PRS___ Dedicated Models
 PRS-35(40)(45) Clamp-Style Universal Models

1. Color: Black, silver or white
2. 25 lb load capacity
3. Three independent axes for precise image alignment
4. Tilt: +20 /-5°, Roll: ±10°, Swivel: 360° with extension column
5. Flush ceiling mountable for a low-profile installation; other mounting options with accessories
6. Quick-release for easy projector access and maintenance
7. Includes cable management openings to route cords through extension column or direct mount exit
8. Works with Spider® Universal Adapter Plate, model-specific adapter plate or universal clamp-style adapter plate
9. Security hardware included for theft protection
10. Pre-assembled design saves installation time

Spider® Universal



Dedicated



Clamp-Style



Kitted Model



PRS Series Projector Mount:

PRS-KIT0811, PRS-KIT1420, PRS-KIT2026

1. Color: Black
2. 25 lb load capacity
3. Comes in three adjustable height ranges (in 1" increments): 9.6"-12.6", 15.6"-21.6", 21.6"-27.6"
4. Includes standard PRS Series mount, Spider® Universal Adapter Plate, adjustable extension column and ceiling plate
5. Pre-assembled projector mount saves installation time

PJF2 Series Projector Mount:

PJF2-UNV(-S) Spider® Universal Models
 PJF2___ Dedicated Models
 PJF235(40)(45) Clamp-Style Universal Models

1. Color: Black or silver
2. 50 lb load capacity
3. Single-adjustment point for quick image alignment
4. Tilt: ±15°, Roll: ±15°, Swivel: 360°
5. Flush ceiling mountable for a low-profile installation; other mounting options with accessories
6. Quick-release for easy projector access and maintenance
7. Includes cable management opening to route cords through extension column
8. Works with Spider® Universal Adapter Plate, model-specific adapter plate or universal clamp-style adapter plate
9. Security hardware included for theft protection
10. Pre-assembled projector mount saves installation time

Spider® Universal



Dedicated



Clamp-Style



Security Mounts and Accessories

You can choose up to four levels of security to protect your projector with Peerless mounts. First, our mounts are offered standard with security fasteners at each connection point. Second, theft-deterrent cables are applied either directly to the projector chassis or wrapped around the carrying handle to visually and physically deter theft. Third, we add a key-lock that protects all the security attachment hardware. Fourth, for the maximum prevention of loss and vandalism, Peerless enclosures completely protect the projector and mount and offer the ultimate in visual theft deterrence and physical security. Whichever level of protection, you can be assured that Peerless offers the professional-grade quality you can trust.

Projector Security Mount: PSM-UNV(-S)(-W) P/JF2-style PSMU-PRS(-S)(-W) PRS-style

1. Color: Black, silver or white
2. Load capacity: PSM-UNV - 50 lb, PSMU-PRS - 25 lb
3. Two-piece hinged tray design with key lock security protects projector attachment hardware
4. Universal tray pattern accommodates most projectors
5. Easy projector access without compromising security
6. Slide-out tray for quick projector removal
7. Integrated cable management
8. 360° swivel with extension column
9. PSM-UNV Tilt: $\pm 15^\circ$, Roll: $\pm 15^\circ$
PSMU-PRS Tilt: $+20^\circ / -5^\circ$, Roll: $\pm 10^\circ$

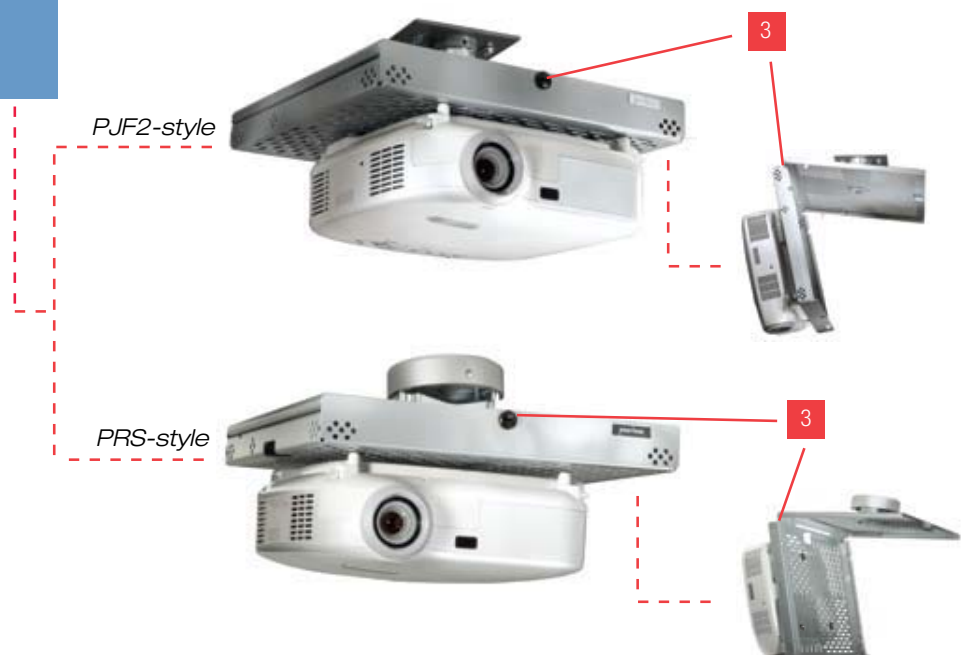

Projector Enclosure: PE1120(W)

1. Color: Black or white
2. Fully encloses around projector and mount for theft-deterrence and projector protection
3. Inside dimensions: 11" height x 20" wide x 20" deep
4. Adjustable bar position to accommodate projector lens location
5. Free-spinning solid steel bars resist cutting
6. Includes patented security fasteners offered exclusively by Peerless
7. May be secured via padlocks
8. Mounts to extension column, drop ceiling plate or structural ceiling
9. Adjustable pipe clamp fits 1" to 1-1/2" pipe
10. Hook-and-hang feature allows hands-free access to projector and mount

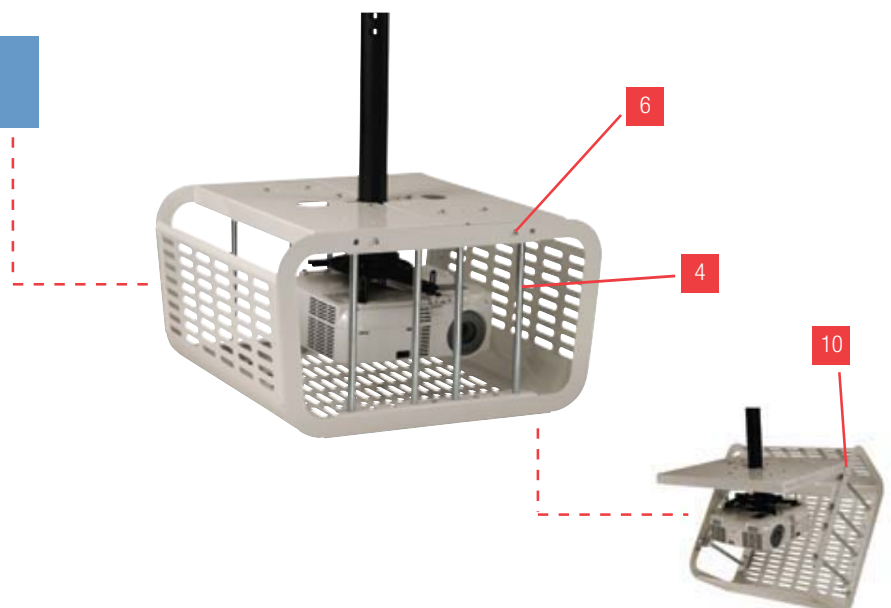

Armor Lock™ Plus Security Cable with Equipment Slot Lock: ACC020

- 1. Can be used with any projector with a built in security slot lock
- 2. Features a security slot lock with a security cable and attachment plate for the projector mount.
- 3. Ships with a 3/16" diameter cable, a Kensington® lock, security screws, security allen wrench, and an attachment plate



Armor Lock™ Plus Security Cable: ACC021

- 1. Can be used with any projector
- 2. Ships with 1/4" diameter cable, security screws, security allen wrench, permanent high-strength adhesive, and an attachment plate
- 3. Can be attached with either a security screw or high-strength adhesive



Projector Wall Arm: PWA14(S)(W)

- 1. Color: Black, silver or white
- 2. 14" long arm provides versatile wall mounting option
- 3. Installs to wood stud
- 4. Metal stud or concrete mounting option with accessory
- 5. 50 lb load capacity



Lightweight Adjustable Suspended Ceiling Kit: CMJ500

- 1. Mounts above 2' x 4' or 2' x 2' false ceiling tile
- 2. Includes tie wire supports, flush mount tube and offers two knockout panels for outlet boxes
- 3. Offers unlimited adjustment for projector placement
- 4. 60 lb load capacity



Variable Position Suspended Ceiling Kit: CMJ453

- 1. Five different attachment options
- 2. Includes tie wire supports, flush mount tube and offers two knockout panels for outlet boxes
- 3. Higher load capacity for use with heavyweight projector mounts
- 4. 250 lb load capacity



Lightweight Suspended Ceiling Kit: CMJ455

- 1. Five different projector mount attachment points
- 2. Includes tie wire supports, flush mount tube and offers two knockout panels for outlet boxes
- 3. May either replace a 2' x 2' false ceiling tile or mount above an existing 2' x 4' or 2' x 2' ceiling tile
- 4. 50 lb load capacity



Finished or Structural Ceiling Plates: CMJ470(W), CMJ480(W), CMJ490(W)

- 1. Color: Black or white
- 2. CMJ470(W) mounts to two wood joists 16" on center
- 3. CMJ480(W) mounts to two wood joists 20" on center
- 4. CMJ490(W) mounts to two wood joists 24" on center
- 5. Can also be mounted directly to concrete (accessory required)



Internal Joist Mount: ACC120

- 1. Attaches between two wood joists 16" or 20" on center
- 2. Attachment point may be positioned at any point within 3" on either joist
- 3. 300 lb load capacity



Round Ceiling Plate: ACC571

- 1. ACC571 includes flush mount tube, EXT002
- 2. Mounts to finished or structural ceiling
- 3. Features a cord management access hole
- 4. 150 lb load capacity



Truss Ceiling Adapter: ACC557

- 1. Attaches to a square, round, rectangular or I-Beam truss up to 3" outside diameter
- 2. 120 lb load capacity



Unistrut® Adapter: ACC550

- 1. For use with 1-5/8" x 1-5/8" Unistrut®
- 2. 250 lb load capacity



Unistrut® or Structural Ceiling Plates: CMJ300, CMJ310

- 1. CMJ300 is a 4" x 4" ceiling plate
- 2. CMJ310 is a 8" x 8" ceiling plate
- 3. Designed for Unistrut® (1-5/8" x 1-5/8" Unistrut®) or solid structural ceiling (mounting hardware not included)
- 4. 250 lb load capacity



I-Beam Clamps:
ACC558, ACC559

1. ACC558 clamps onto 4"-8" I-Beam
2. ACC559 clamps onto 7"-12" I-Beam
3. 250 lb load capacity



Lightweight Cathedral Ceiling:
ACC912

1. 120 degrees of adjustment (+/- 60 degrees)
2. Compact, lightweight and easy to install
3. 75 lb load capacity



Anti-Vibration Ceiling Plates:
ACC840, ACC845

1. ACC840 for structural ceiling (wood only)
2. ACC845 for Unistrut® ceiling (1-5/8" x 1-5/8" Unistrut®)
3. Reduces unwanted vibrations that may cause the screen image to vibrate
4. Features two cord management access holes
5. Patent pending
6. 60 lb load capacity



Extension Column Stabilizer Kit:
ACC050

1. Used to reduce unwanted swaying that may occur with longer extension columns
2. Includes a pipe clamp, two stabilizer column supports and hardware for mounting to wood joists



Side-To-Side Adjuster:
ACC830

1. Provides 4" of radial adjustment side to side for precise lateral positioning
2. Can also be used in conjunction with cord management adapters and Projector Wall Arm, PWA14(S)(W)
3. Includes flush mount tube, EXT002



Extension Column Connector:
ACC109

1. Used to join two extension columns to create a maximum length of 20'



Cord Management Adapter:
ACC800 / ACC850(S)

1. Color: ACC800 - black, ACC850 - black or silver
2. Designed to route cords internally through an extension column
3. Features a 1-1/2" cord management access hole
4. ACC800 threads in between the projector mount and extension column. (Can also be used between the extension column and ceiling plate)
5. ACC850 used to join two extension columns to create a maximum length of 20'



Fixed Length Column:
EXT Models

1. Column lengths available from 6"-10'
2. Standard 1-1/2"-11.5 NPT schedule 40 pipe
3. Both ends notched for safety locking



Adjustable Length Extension Column:
ADJ Models

1. Adjustable column lengths available from 8"-12'(1" increments)
2. Standard 1-1/2"-11.5 NPT schedule 40 pipe
3. Both ends notched for safety locking



Cord Wrap:
ACC852(S)(W), ACC856(S)(W)

1. Color: Black, silver or white
2. ACC852 consist of four 2' sections
3. ACC856 consist of four 6' sections
4. Designed to externally route cords along outside of extension column
5. Sections can be stacked to create longer lengths or cut to desired length



Esucutcheon Ring:
ACC640

1. Covers hole where extension column passes through ceiling
2. Hinged ring wraps around extension column (not needed with CMJ453)



ALLIGATOR® Concrete Anchors:
ACC203, ACC204, ACC250

1. ACC203 contains 3 anchors
2. ACC204 contains 4 anchors
3. ACC250 contains 50 anchors
4. For attachment to concrete or cinder block
5. Used in conjunction with wood screws (supplied with projector mount and/or ceiling plate)
6. Expands in length and binds to contours of hole and screw





About Peerless Industries, Inc.

For more than 40 years, Peerless has designed and manufactured the world's most comprehensive line of professional-grade audio/visual mounting systems for flat panel TVs, projectors, televisions, speakers, security cameras, computers and other technology accessories used in both the commercial and consumer markets. Built on decades of experience and proven expertise, Peerless offers its customers the best overall value by providing the right combination of high performance mounting solutions, affordable pricing and complete services and support. Peerless Industries is ISO 9001 certified and is an approved Underwriters Laboratories testing site.

Peerless Industries, Inc.
3215 W. North Avenue
Melrose Park, IL 60160 USA

Toll Free: 800-865-2112 708-865-8870
Fax: 708-865-2941

www.peerlessmounts.com

© 2009 Peerless Industries, Inc. All rights reserved.

LIT-0155 rev.2